

HVAC DEMOLITION FLOOR PLAN
1/8" = 1'-0"
NORTH

GENERAL DEMOLITION NOTES

1. VERIFY FIELD CONDITIONS PRIOR TO BIDDING. PLANS MAY NOT INDICATE EACH DEVICE TO BE REMOVED, OR INDICATE NECESSARY RELOCATION OF EQUIPMENT OR HVAC SYSTEMS.
2. DISCONNECT, DEMOLISH, AND REMOVE MECHANICAL SYSTEMS, EQUIPMENT AND COMPONENTS INDICATED TO BE REMOVED. DISPOSE OF DEMOLISHED EQUIPMENT AND MATERIALS IN COMPLIANCE WITH LOCAL AUTHORITIES HAVING JURISDICTION.
- 2.1. PIPING/DUCTWORK TO BE REMOVED: REMOVE PORTION OF PIPING/DUCTWORK INDICATED TO BE REMOVED AND CAP OR PLUG REMAINING PIPING/DUCTWORK WITH SAME OR COMPATIBLE MATERIAL.
- 2.2. PIPING TO BE ABANDONED IN PLACE: DRAIN PIPING/DUCTWORK AND CAP OR PLUG PIPING/DUCTWORK WITH SAME OR COMPATIBLE MATERIAL. PENETRATIONS THROUGH ROOF CONSTRUCTION SHALL BE INSULATED AND SEALED WEATHERTIGHT.
- 2.3. EQUIPMENT TO BE REMOVED: DISCONNECT SERVICES AND REMOVE EQUIPMENT. REMOVE PIPING/DUCTWORK AND CAP OR PLUG AT MAIN WITH SAME OR COMPATIBLE MATERIAL.
- 2.4. EQUIPMENT TO BE REPLACED: DISCONNECT SERVICES AND REMOVE EQUIPMENT. MODIFY EXISTING SERVICES AS NECESSARY TO ACCEPT NEW EQUIPMENT.
- 2.5. EQUIPMENT TO BE RELOCATED: DISCONNECT SERVICES AND REMOVE. CLEAN AND STORE EQUIPMENT. REMOVE PIPING/DUCTWORK AND CAP OR PLUG AT MAIN WITH SAME OR COMPATIBLE PIPING MATERIAL. WHEN APPROPRIATE, REINSTALL, RECONNECT, AND MAKE EQUIPMENT OPERATIONAL.
- 2.6. EQUIPMENT TO BE SALVAGED: DISCONNECT SERVICES AND REMOVE EQUIPMENT AND DELIVER TO OWNER. REMOVE PIPING/DUCTWORK AND CAP OR PLUG AT MAIN WITH SAME OR COMPATIBLE MATERIAL.
3. IF PIPING/DUCTWORK, INSULATION OR EQUIPMENT TO REMAIN IS DAMAGED IN APPEARANCE OR IS UNSERVICEABLE, REMOVE DAMAGED OR UNSERVICEABLE PORTIONS AND REPLACE WITH NEW PRODUCTS OF EQUAL CAPACITY AND QUALITY.
4. REFER TO DRAWINGS OF OTHER DIVISIONS FOR ADDITIONAL DEMOLITION WORK.
5. COORDINATE INTERRUPTION OF EXISTING SERVICE(S) WITH THE OWNER AND GENERAL CONTRACTOR. DO NOT INTERRUPT SERVICE(S) TO FACILITIES OCCUPIED BY OWNER OR OTHERS WITHOUT WRITTEN PERMISSION FROM THE OWNER AND GENERAL CONTRACTOR.
6. PROVIDE ALL CUTTING AND PATCHING AS NECESSARY. INSULATE, CAP, AND SEAL EXTERIOR ROOF AND WALL PENETRATIONS TO BE WEATHER-TIGHT. REFER TO SPECIFICATIONS FOR ADDITIONAL CUTTING AND PATCHING REQUIREMENTS.

SHEET KEYNOTES

1. EXISTING SUPPLY FAN TO BE REMOVED. INSULATE EXISTING ROOF CURB TO MATCH SURROUNDING ROOF INSULATION AND CAP IN A WATER-TITE MANNER.
2. EXISTING EXHAUST FAN TO BE REMOVED. REMOVE EXISTING ROOF CURB AND MAKE READY FOR INSTALLATION OF NEW ROOF CURB AND KITCHEN EXHAUST FAN.
3. EXISTING KITCHEN HOOD TO BE REMOVED.
4. EXISTING ROOF TOP UNIT, ASSOCIATED DUCTWORK, AND APPURTENANCES TO BE REMOVED.
5. EXISTING RETURN GRILLE AND ANY ASSOCIATED DUCTWORK TO BE REMOVED.

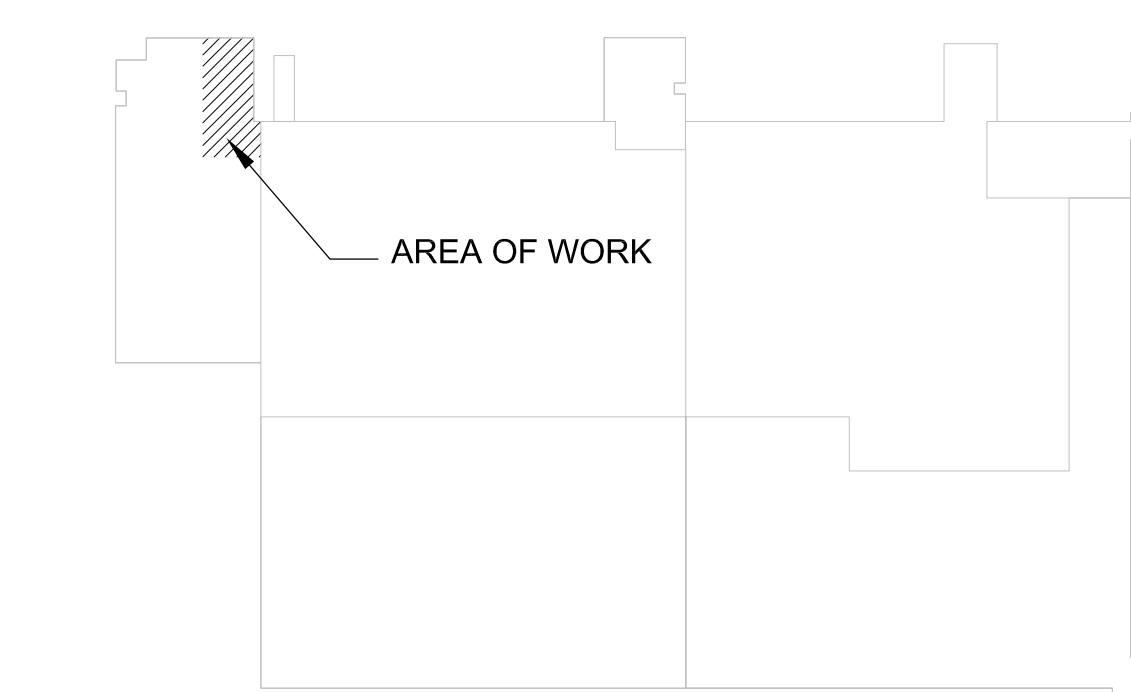

KEY PLAN
NOT TO SCALE

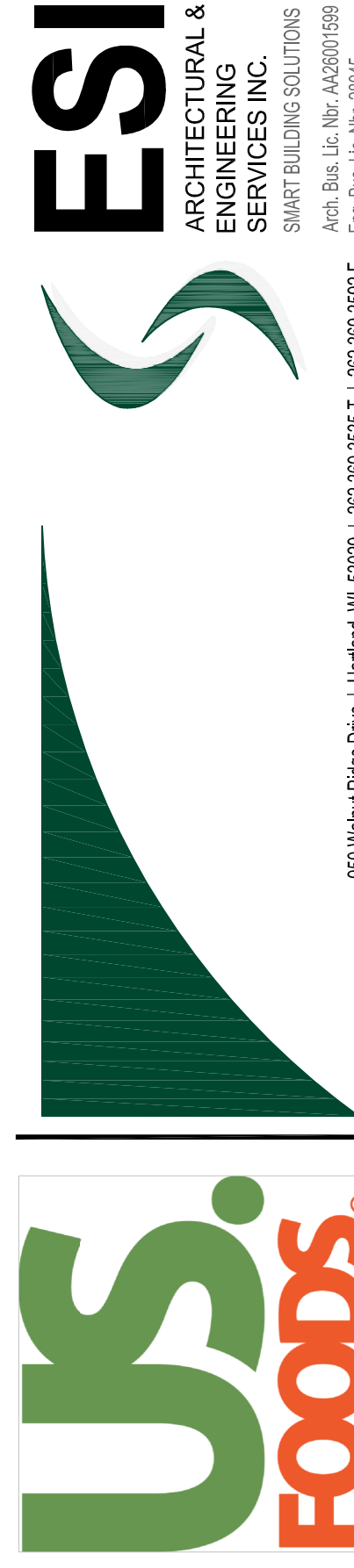

KITCHEN RENOVATION FOR
US FOODS - SOUTH FLORIDA
7598 NW 6TH AVENUE
BOCA RATON, FL 33487

REVISIONS	
△	1
△	2
△	3
△	4
△	5
△	6
△	7
△	8
△	9
△	10

DATE	JOB NO.
1-6-20	50-1414-19
DWG BY	CHKD BY
AMK	JRO

SHEET TITLE
HVAC
DEMOLITION
FLOOR PLAN

PRELIMINARY DWGS.	
FINAL CONST. DWGS.	■
SHEET NUMBER	

H101
HVAC