

C:\Users\ashley\Documents\190898_Annotation_ashley.rvt
2/1/2025 3:51:02 PM

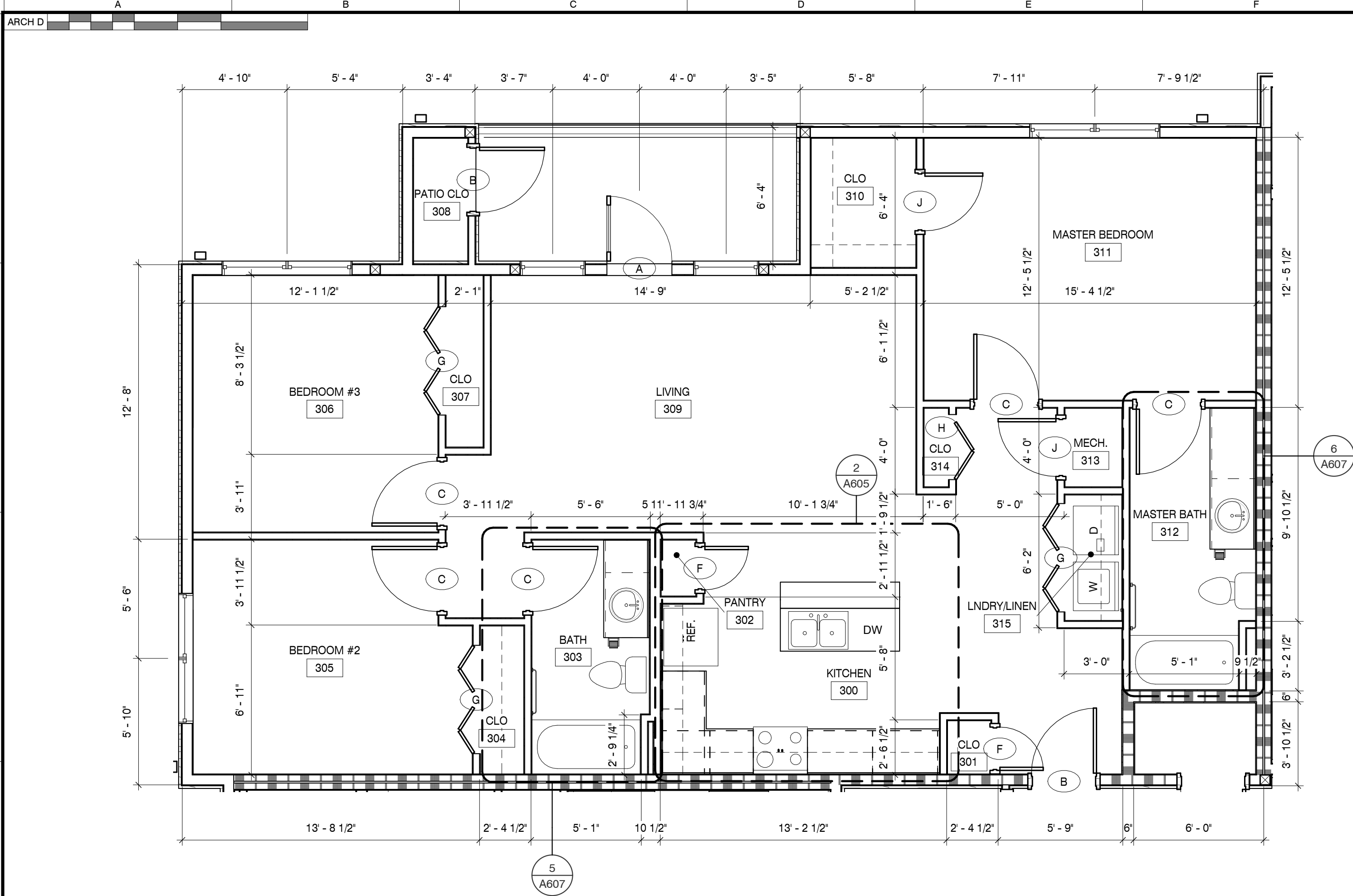

TYPICAL 3 BEDROOM UNIT

SCALE: 1/4" = 1'-0"

1

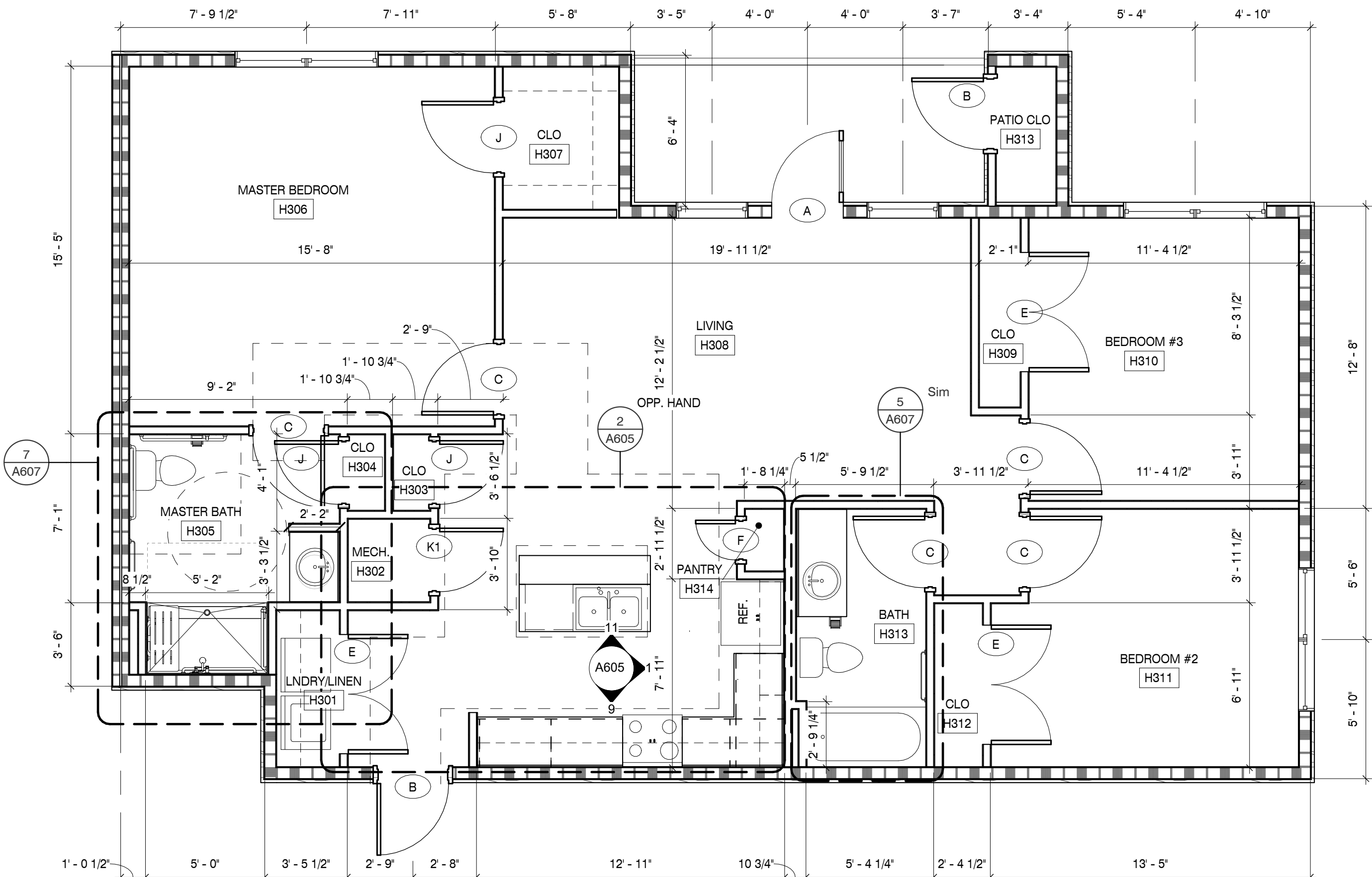

3 BEDROOM UNIT - TYPE "A" UNIT

SCALE: 1/4" = 1'-0"

TYPE A UNIT - PROVIDE TUB IN UNIT UNLESS MARKED FOR SHOWER UNIT, REF SHEET CVR.3
*FAIR HOUSING PATH DENOTED WITH DASHED LINE

2

GENERAL NOTES

- SEE ADDRESSING SHEET FOR FAIR HOUSING UNIT LOCATIONS AND A6 SHEETS FOR DETAILS. FOR CLUBHOUSE REFERENCE SHEET A8.8 FOR ACCESSIBILITY DETAILS.
- ALL GROUND LEVEL UNITS ARE TO BE BUILT AS TYPE A&B UNLESS OTHERWISE NOTED. (FAIR HOUSING)
- ALL DETAILS OF CONSTRUCTION SHALL CONFORM WITH THE 6TH EDITION OF THE 2017 FBC.
- ALL INTERIOR DIMENSIONS ARE TO FACE OF STUD UNLESS OTHERWISE NOTED. *CLEAR* DENOTES FINISH TO FINISH DIMENSIONS.
- ALL EXTERIOR DIMENSIONS ARE TO FACE OF FOUNDATION WALL, UNLESS OTHERWISE NOTED
- MOUNT FIRE EXTINGUISHERS LISTED IN SPECIFICATIONS AT LOCATIONS SHOWN AND/OR DIRECTED BY FIRE DEPARTMENT/CODE OFFICIALS.
- FURNISH AND INSTALL SOLID BACKING FOR ALL FIXTURES AND EQUIPMENT.
- PROVIDE WATER RESISTANT GYP. BD. AT ALL WET LOCATIONS.
- PROVIDE WIRE SHELF WITH HANGER ROD IN ALL CLOSETS AND LAUNDRY ROOMS
- THIRD FLOOR ONLY: 2' - 3' SIZE CEILING ACCESS PANEL, UL APPROVED FOR 1HR RATED CEILING ASSEMBLY, SEE 6/A1.1.2
- HIDE ALL EXPANSION JOINTS (EJ) BEHIND DOWNSPOUTS
- PROVIDE PEEL AND STICK FLASHING AROUND ALL DOORS AND WINDOWS. SEE SHEET A2.2
- WASHING MACHINES AND DRYERS TO BE PROVIDED AND INSTALLED BY THE CONTRACTOR.

WALL LEGEND

- EXTERIOR WALL**
STONE VENEER OVER METAL LATH OVER HOUSE WRAP OVER 1/2" EXTERIOR SHEATHING ON 2X6 WOOD STUDS 16" O.C. W/ 1/2" GYP. BD. ON INTERIOR. PROVIDE R-19 UNFACED BATT INSULATION. REFER TO EXTERIOR ELEVATIONS FOR STONE VENEER HEIGHTS
- EXTERIOR WALL**
STONE VENEER OVER METAL LATH OVER HOUSE WRAP OVER 1/2" EXTERIOR SHEATHING ON 2X6 WOOD STUDS 16" O.C. W/ 1/2" GYP. BD. ON INTERIOR. PROVIDE R-19 UNFACED BATT INSULATION. REFER TO EXTERIOR ELEVATIONS FOR BRICK VENEER HEIGHTS
- EXTERIOR WALL**
SIDING OVER HOUSE WRAP OVER 1/2" EXTERIOR SHEATHING ON 2X6 WD STUDS 16" O.C. W/ 1/2" GYP. BD. ON INTERIOR. PROVIDE R-19 UNFACED BATT INSULATION.
- 1 HOUR RATED BREEZEWAY WALL**
SIDING OVER HOUSE WRAP OVER 1/2" EXTERIOR SHEATHING ON 2X6 WD STUDS W/ 5/8" FIRE RATED GYP. BD. ON INTERIOR. PROVIDE R-13 BATT INSULATION. BUILD IN ACCORDANCE WITH UL#356
- 1 HOUR TENANT SEPARATION WALL**
DOUBLE 2X STUD WALL W/ 1 LAYER FIRE RATED 5/8" GYP. BD. ON OUTER SIDES AND 1 LAYER 1/2" PLYWOOD ON INSIDE OF ONE WALL. PROVIDE TWO LAYERS R-13 BATT INSULATION. BUILD WALL IN ACCORDANCE W/ UL #341.
- INTERIOR WALL PARTITION**
2X4 WOOD STUDS W/ 1 LAYER OF 1/2" GYP. BD. EACH SIDE.
- INTERIOR WALL PARTITION**
2X6 WOOD STUDS W/ 1 LAYER OF 1/2" GYP. BD. EACH SIDE.
- EJ = EXPANSION JOINT

- NOTES:
1. REFER TO STRUCTURAL DRAWINGS FOR STUD SPACING ON ALL WALLS.
2. 1/2" GYP. BD. IS TO BE USED IN LIEU OF 5/8" GYP. BD. AT ALL NON-RATED PARTITIONS
3. SEE A6 SHEETS FOR ENLARGED UNIT PLANS

- 1A 1 - HOUR RATED WALL, UL# U356
1B 1 - HOUR RATED WALL, UL# U341

FINISH SCHEDULE:

ROOM	WALLS	FLOORS	BASE	CEILING	NOTES
LIVING	PAINT	VINYL PLANK	WOOD	PAINT	REF. SHEET A8.5
KITCHEN	PAINT	VINYL PLANK	WOOD	PAINT	--
BATHROOM	PAINT	VINYL PLANK	WOOD	PAINT	--
BEDROOMS	PAINT	CARPET	WOOD	PAINT	--
HALLWAY	PAINT	VINYL PLANK	WOOD	PAINT	--

MBI

MBI COMPANIES INC.
100 COLONIAL CENTER SUITE 230
LAKE MARY, FL 32746
PHONE: (407) 585-0330
FAX: (407) 585-0336
WEB: mbicompanies.com
ARCHITECTURE NO.: AA26000828
INTERIORS NO.: IB26000665

CONSULTANT

SEAL



COPYRIGHT © MBI COMPANIES INC. 2019
THE DESIGN PROFESSIONAL DENIES ANY AND ALL RESPONSIBILITY AND LIABILITY FOR PROBLEMS WHICH ARISE FROM FAILURE TO FOLLOW THESE PLANS, SPECIFICATIONS AND THE DESIGN INTENT THEY CONVEY, OR PROBLEMS WHICH ARISE FROM OTHERS' FAILURE TO OBTAIN AND/OR FOLLOW THE DESIGN PROFESSIONAL'S GUIDANCE WITH RESPECT TO ANY ERRORS, OMISSIONS, INCONSISTENCIES, AMBIGUITIES OR CONFLICTS WHICH ARE ALLEGED.

PROJECT INFORMATION

PROJECT:

WESTWOOD AT WINTER HAVEN APARTMENTS

PROJECT ADDRESS:

Avenue G
Winter Haven, FL 36801
HUD# 067-35554

PROJECT NO.: 180888

ACTIVE DESIGN PHASE

- ☐ FOR REVIEW ONLY
☐ FOR PERMITTING ONLY
☐ SCHEMATIC DESIGN
☐ DESIGN DEVELOPMENT
☐ CONSTRUCTION BIDDING
☒ CONSTRUCTION DOCUMENTS
☐ AS-BUILT RECORD SET

REVISION INFORMATION

NO.	DATE	DESCRIPTION

KEY PLAN

SHEET INFORMATION

SHEET ISSUED: 03-25-19
DESIGNED BY: MES
DRAWN BY: AV
REVIEWED BY: CMG
SHEET TITLE:

TYPICAL 3 BEDROOM UNIT PLANS AND DETAILS

SHEET NO.:

A603