

C:\Users\jgarcia\Documents\190589_Annotation_jgarcia055.rvt
5/28/2019 9:53:00 AM

ARCH D

8

7

6

5

4

3

2

1

#

KEYED NOTES - ROOF FRAMING PLAN

- 1 ROOF SHEATHING TO BE 15/32" CDX PLYWOOD. FASTEN PLYWOOD WITH 8d COMMON NAILS @ 4" O.C. AT SUPPORTED PANEL EDGES (E.N.) AND @ 12" O.C. FIELD (F.N.). PROVIDE PLYCLIPS AT UNSUPPORTED PLYWOOD EDGES.
- 2 ATTIC ACCESS SEE ARCH. ROOF PLAN

GIRDER TRUSS CONNECTIONS TO BE DESIGNED BY E.O.R. AFTER REVIEW OF TRUSS SUBMITTALS

LINTEL SCHEDULE				
TYPE	SIZE		COMMENTS	
L1	(3) 2X10 W/ 1/2" PLYWOOD SPACERS		(2) JAMB STUDS (2) KING STUDS	
L2	(3) 1 3/4" X 11 1/4" MICROLLAM LVL		(2) JAMB STUDS (4) KING STUDS	
L3	(3) 2X8 W/ 1/2" PLYWOOD SPACERS		(2) JAMB STUDS (2) KING STUDS	
L4	5 1/4" X 11 1/4" LVL		(2) JAMB STUDS (2) KING STUDS	

SHEAR WALL SCHEDULE				
MARK	LEVEL	WALL SHEATHING MARK	SILL AND BOTTOM PLATE ANCHORAGE MARK	HOLDOWN MARK
SW-A				
SW-A	1	PS1	SPL1	HD2
SW-A	2	PS1	BPL1	ST1
SW-B				
SW-B	1	PS2	SPL1	HD1
SW-B	2	PS1	BPL1	ST1
SW-C				
SW-C	1	PS1	SPL1	HD1
SW-C	2	PS1	BPL1	ST1
SW-D				
SW-D	1	PS3	SPL1	HD4
SW-D	2	PS2	BPL2	ST2
SW-D	3	PS1	BPL1	ST1
SW-E				
SW-E	1	PS2	SPL1	HD3
SW-E	2	PS1	BPL2	ST1
SW-E	3	PS1	SPL1	ST1
SW-F				
SW-F	1	PS2	SPL1	HD2
SW-F	2	PS1	BPL1	ST1
SW-G				
SW-G	1	PS3	SPL1	HD3
SW-G	2	PS1	BPL1	ST1
SW-H				
SW-H	1	PS2	SPL1	HD2

LOAD BEARING WALL STUD SCHEDULE KEY				
DESCRIPTION	LEVEL			FOUNDATION LOADS
	1	2	3	
DOUBLE PARTY WALL	2X4 @ 16"	2X4 @ 16"	2X4 @ 16"	4.5 klf
EXTERIOR WALL	2X6 @ 16"	2X6 @ 16"	2X6 @ 16"	2.7 klf
TYPICAL WALL	2X6 @ 16"	2X6 @ 16"	2X6 @ 16"	3.2 klf

*ALL FRAMING LUMBER SHALL BE #2 SYP EXCEPT STUDS AND PLATES MAY BE STUD GRADE SYP. UNLESS NOTED OTHERWISE.

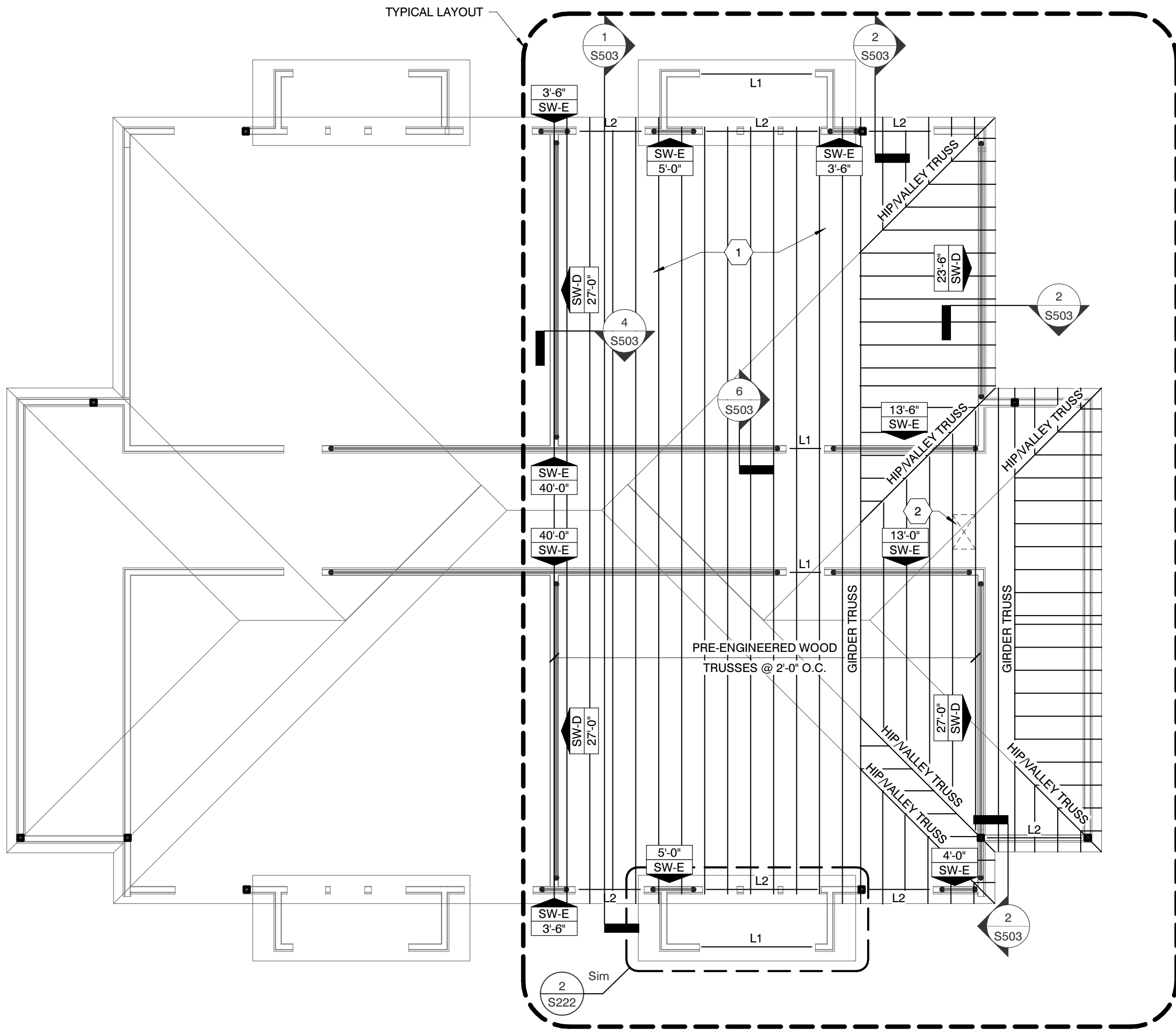

BUILDING TYPE 3 - FRAMING PLAN - FRAMING BEARING ELEV = 28' - 4 7/8"

SCALE: 1/8" = 1'-0"

1

MBI

MBI COMPANIES INC.
100 COLONIAL CENTER SUITE 230
LAKE MARY, FL 32746
PHONE: (407) 585-0330
FAX: (407) 585-0336
WEB: mbicompanies.com
ARCHITECTURE NO.: AA26000828
INTERIORS NO.: IB26000665

CONSULTANT
STRUCTURAL ENGINEER:

MBI COMPANIES INC.
298 N. WEISGARBER ROAD
KNOXVILLE, TN 37919
PHONE: (865) 584-0999
FAX: (865) 584-5213
WEB: mbicompanies.com

SEAL

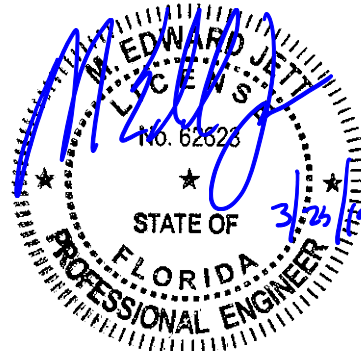

COPYRIGHT © MBI COMPANIES INC. 2019
THE DESIGN PROFESSIONAL DENIES ANY AND ALL RESPONSIBILITY AND LIABILITY FOR PROBLEMS WHICH ARISE FROM FAILURE TO FOLLOW THESE PLANS, SPECIFICATIONS AND THE DESIGN INTENT THEY CONVEY, OR PROBLEMS WHICH ARISE FROM OTHERS' FAILURE TO OBTAIN AND/OR FOLLOW THE DESIGN PROFESSIONAL'S GUIDANCE WITH RESPECT TO ANY ERRORS, OMISSIONS, INCONSISTENCIES, AMBIGUITIES OR CONFLICTS WHICH ARE ALLEGED.

PROJECT INFORMATION

PROJECT:

WESTWOOD AT
WINTER HAVEN
APARTMENTS

PROJECT ADDRESS:

Avenue G
Winter Haven, FL 36801
HUD# 067-35554

PROJECT NO.: 180888

ACTIVE DESIGN PHASE

- ☐ FOR REVIEW ONLY
☐ FOR PERMITTING ONLY
☐ SCHEMATIC DESIGN
☐ DESIGN DEVELOPMENT
☐ CONSTRUCTION BIDDING
☒ CONSTRUCTION DOCUMENTS
☐ AS-BUILT RECORD SET

REVISION INFORMATION

NO. DATE DESCRIPTION

NO.	DATE	DESCRIPTION

KEY PLAN



SHEET INFORMATION

SHEET ISSUED: 03-25-19
DESIGNED BY: KRG
DRAWN BY: JCP
REVIEWED BY: RMG
SHEET TITLE:

BUILDING TYPE 3 -
FRAMING PLAN

SHEET NO.:

S233